

S2131



Dream Paradise

S2131 Instruction manual

# NOTICE OF ASSEMBLE

## Tips for assembling

1. Because this product contains small parts, children need to use this product with an adult to avoid accidental ingestion and cause suffocation hazard. There are sharp objects in the product, be careful not to pierce people to avoid injury.
2. After all the materials are used in the required amount in the operation steps, put the remaining materials back into the original bag until the installation is completed. (Avoid losing materials during the installation process)
3. The unit of dimension marked in the step diagram is "cm".
4. Tips for making template paper: Put the template on the back of the material, fix it with some small double-sided tape, and then cut out the material to prevent the cloth or template from moving in the cutting process, or causing errors in the cut material. Or lead to insufficient materials.
5. According to the "Parts Rule Example" at the bottom of this page, refer to the parts on the part number drawing, find the actual product and compare it with the bill of materials, and then install it after confirming that it is correct. (Wooden parts only)
6. It is not advisable to apply too much glue, so as not to wait for a longer time to dry, and overflow will affect the effect of the finished product.
7. There are unavoidable small deviations in the color of wood, fabric, and beads of different batches, without notice, thanks for understanding.

## Tips for Assembling Wood



Find the corresponding block number, use a knife in the connection point gently press, you can take out the wood.

Use a knife to smooth out the burr.

Or use sandpaper to smooth out the burr

## Testing on LED function

Be sure to test the LED lights before making the lighting, note that the LED white wire to the negative, gray wire to the positive reference to the following figure operation test.



1 DO NOT contact the LED wire end direct to the battery cell.



2 Use the provide battery holder. Make sure the correct polarity.

## How to assemble the battery holder

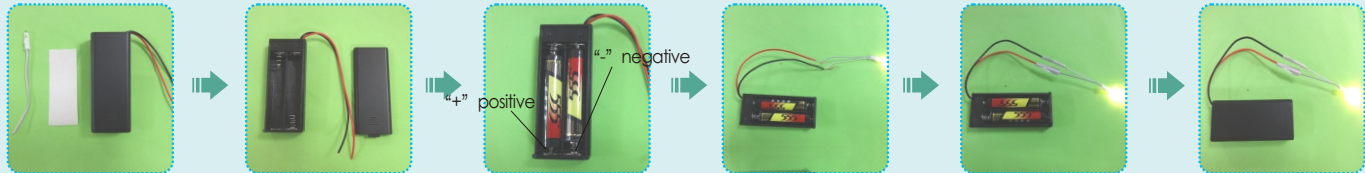

1. Material and tools needed:  
- Battery holder, LED bulb, tape, screw driver and 2 pieces AAA size battery (not provided)

2. Use screw driver and take the lid off from the battery holder.

3. Insert the battery take notes on the polarity.

4. Connect the red wire to grey wire. Connect the black wire to white wire.

5. Wrap the exposed wire with the tapes.

6. Place the box lid and fastness with screw driver.

## Examples of parts rule:

A01: The parts are directly in the box; B01: The parts are in the B bag; C01: The parts are in the C bag, and so on (Note: The printing paper is displayed in the step A07-01: The printing paper is placed directly in the box, The part number is A07-01. In the step, the template paper A07-C01 is displayed. A07 is the template paper, D01 is the cutting template used for the corresponding material, D01-01, D01-02 are the part numbers for the parts, and the printing paper and template paper are directly placed in the packaging box.)

# Table of Contents

Name	Materials Bags	
printing paper & template paper	A bag A11, A12 (all of printing paper and template are in A11, A12, total 4 pieces of A5 paper)	
spinning plane	A bag+B bag+E bag+F bag+printing paper	page 3-4
base of spinning plane	A bag+ F bag+G bag+printing paper	page 4-5
ferris wheel	C bag+E bag+F bag	page 5-6
base of ferris wheel	C bag+F bag+G bag+printing paper	page 6-7
gate&guide board	D bag+printing paper	page 7
bench	D bag	page 7
beach umbrella	D bag+printing paper	page 7
hobbyhorse	D bag+F bag+printing paper	page 8
street lamp	D bag+E bag	page 8
windmills	D bag+E bag+printing paper	page 8
ice cream van	A bag+D bag+E bag+printing paper	page 9-10
steps and flowers	D bag	page 11
balloon	E bag+F bag	page 11
coloured flags	E bag+F bag+printing paper	page 11
outer frame	A bag+B bag+E bag+F bag+G bag+printing paper +template paper	page 11-15
batteries box	G bag	page 15

## Symbol description used

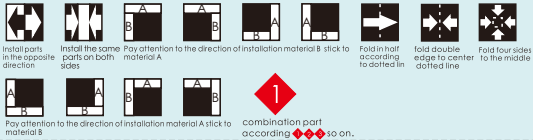

## About the use of glue

Method for using glue:

1. After applying the glue, let it dry for a few seconds before pasting.
2. Fix it slightly with your hands, and finally put it aside to dry;

## Tips:

When pasting the plane printing paper, a piece of waste bank card or telephone card can be used to wipe evenly after the glue is smeared on the wood board, and then the printing paper is pasted to squeeze out the air inside.

## Material List Thumbnail (For Reference Only)

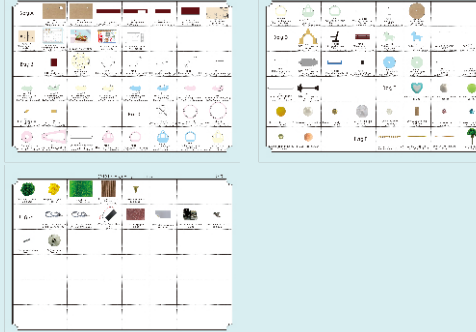

## Printed paper and template paper thumbnail (For Reference Only)

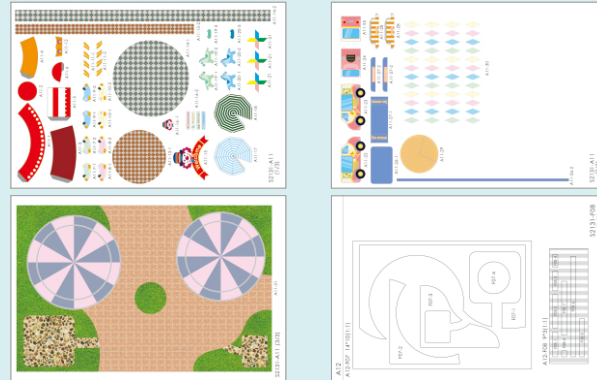

## Types of glue:

- White latex: Used for adhering soft materials, such as wood and paper.
- Alcoholic Glue: Used for adhering hard materials such as cloth, plastic, beads, wire, dust cover, etc.

spinning plane

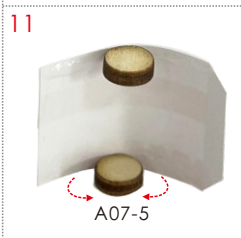
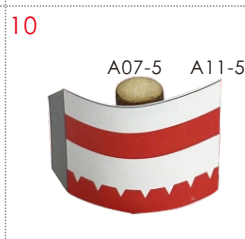
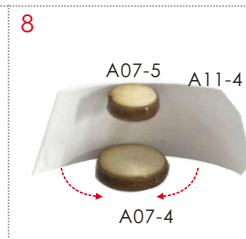
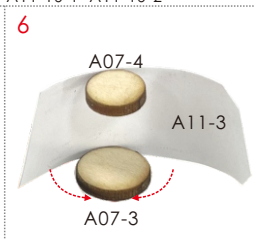
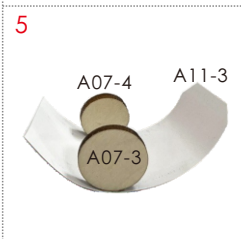
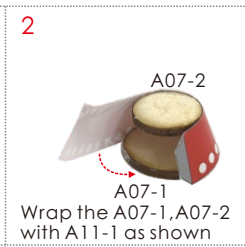
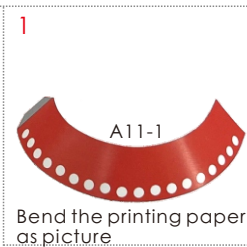
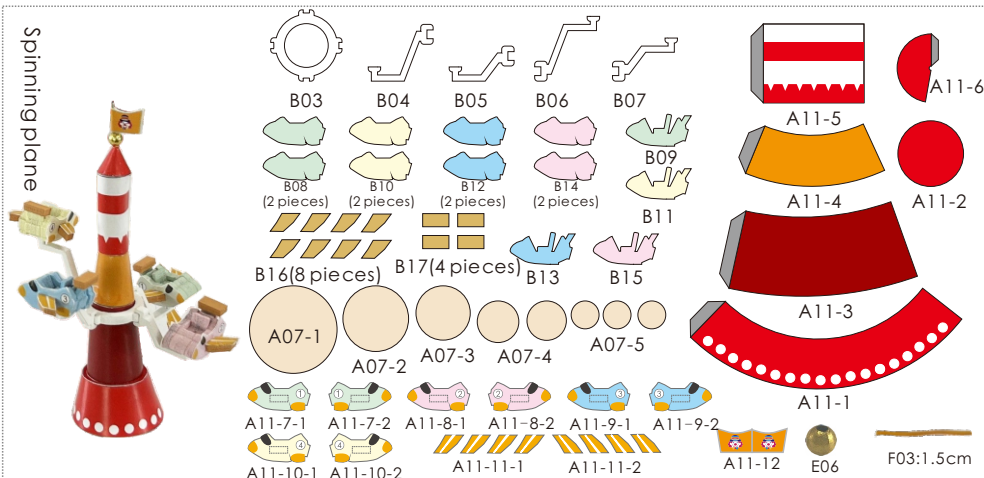

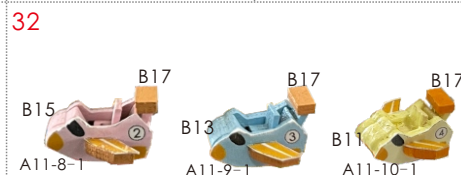
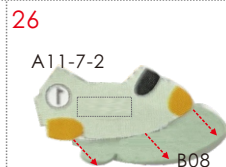
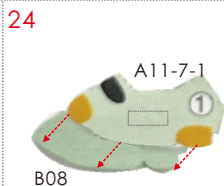
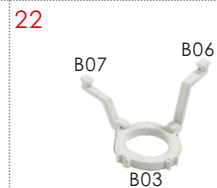

Make 3 pieces according to the previous steps

Base of spinning plane

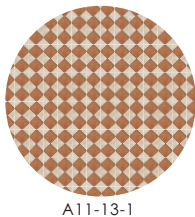
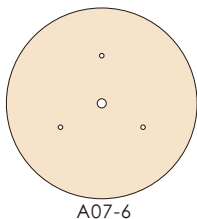

A11-13-2



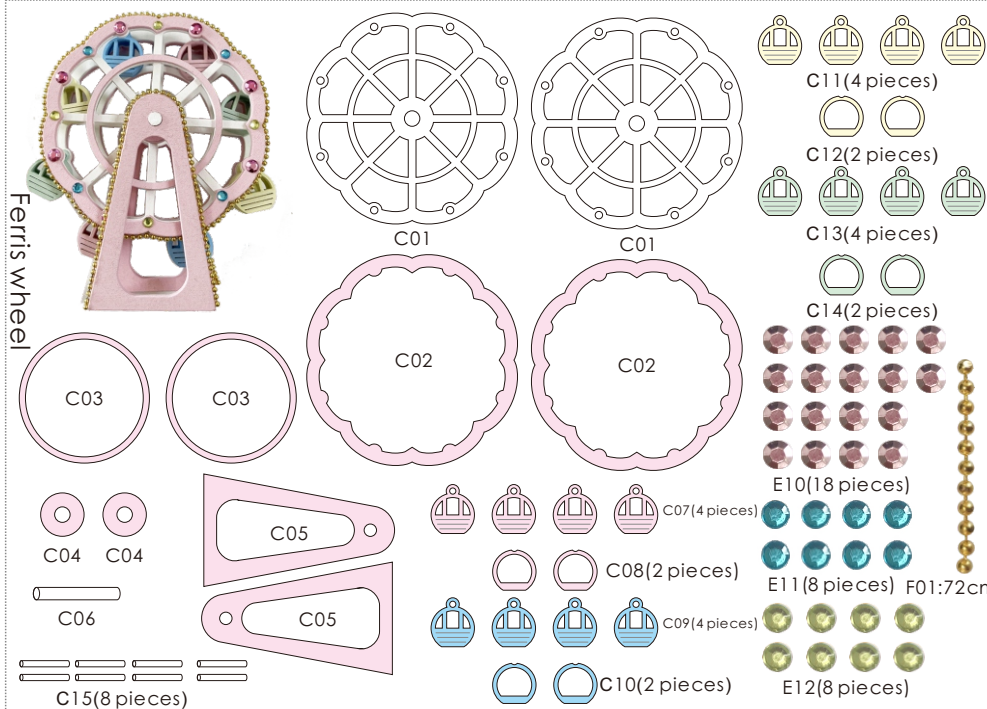
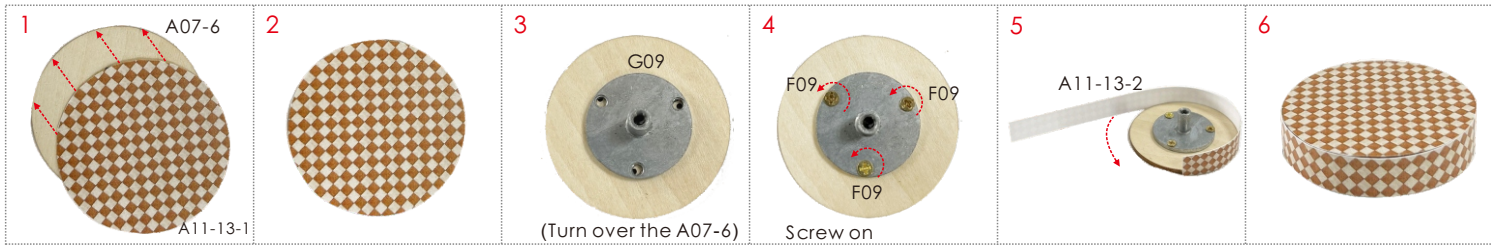

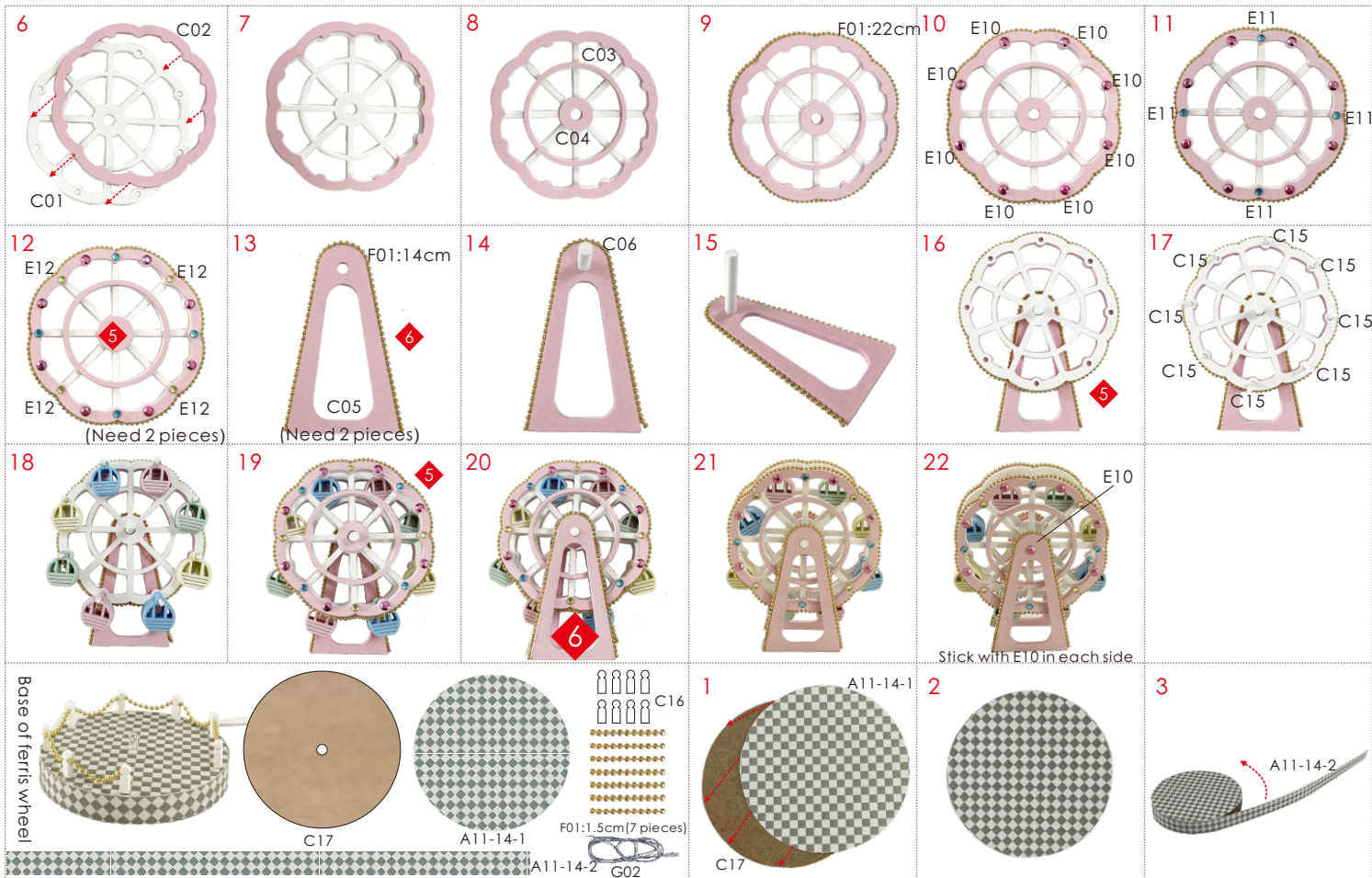

4

5

G02

(Please test the light before assemble)

6

F01:1.5cm  
C16

7

F01:1.5cm  
C16

8

9

Gate & guide board

D01

A11-15  
A11-16-1  
A11-16-2

1

A11-16-1

D09

2

3

A11-15-1  
A11-16-2

4

A11-15

D01

5

Bench

D02(4 pieces)  
D03(4 pieces)

1

D02

D03

2

D03

3

D02  
(Need 2 pieces)

Beach umbrella

D12  
D13  
D15  
D16  
A11-18  
A11-17

1

A11-18

2

3

D15

D13  
0.5cm

4

5

A11-17

D16  
D12

7



Hobbyhorse

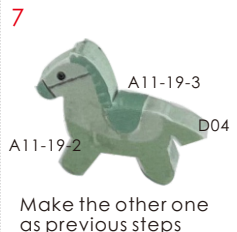
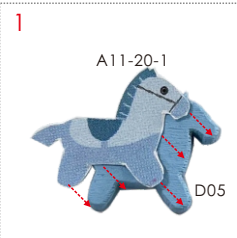
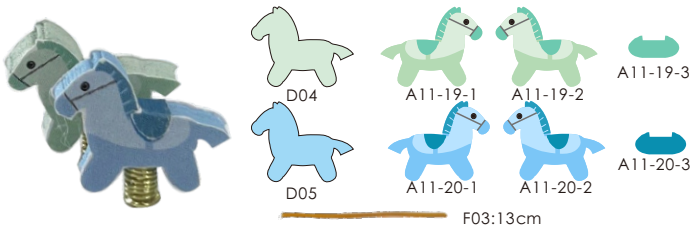

Street lamp



Windmill

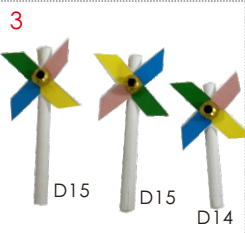
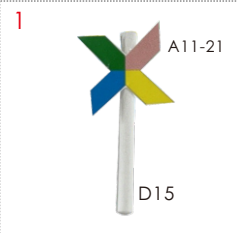
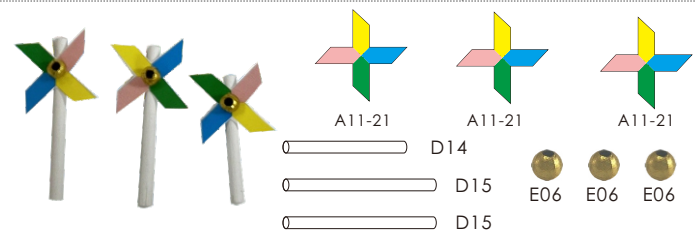

Ice cream van

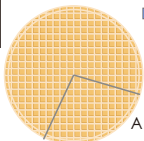
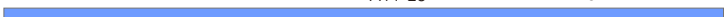
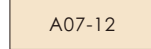
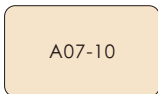
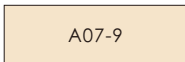
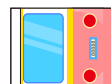
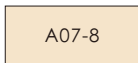

A11-29

E13

A11-26-2

1



A07-7

2



3



A07-7

4



5



A07-9  
Turn  over

6



7



8

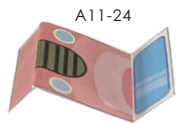

Fold the printing paper as shown

9



10



Fold the printing paper as shown

11



12



A07-10

13



14



15



16



17



18



19

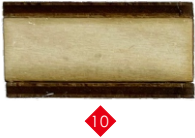

20



21



22



23



24



25



Fold the printing paper as shown

26



27



28



29



30



Fold the printing paper as shown

31



32



33



34



35



Steps

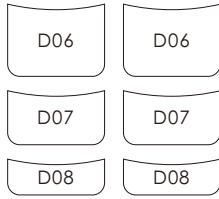

1



2



(Need 2 pieces)

Flowers

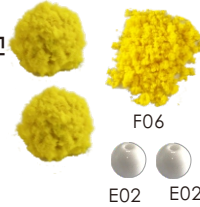

1

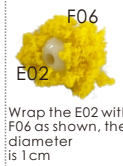

Wrap the E02 with F06 as shown, the diameter is 1cm

2



(Need 2 pieces)

Balloon



1

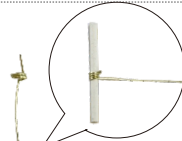

Wrap the F03 around the D14 as picture

2

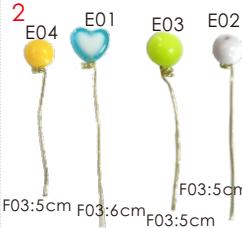

3



4



(Need 2 pieces)

Coloured flags

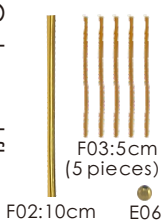

1

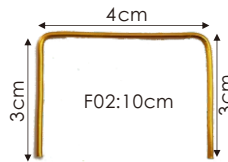

Bend according to A07-13

2



Fix F03 on the F02

3



Repeat the previous steps

4

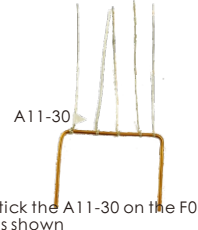

Stick the A11-30 on the F03 as shown

5



6



Fix together with E06

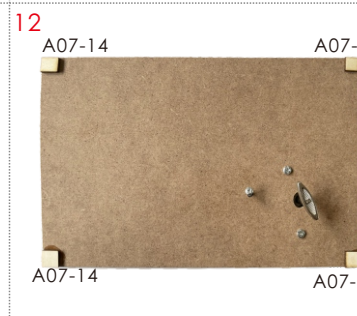
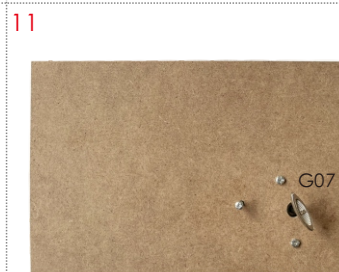
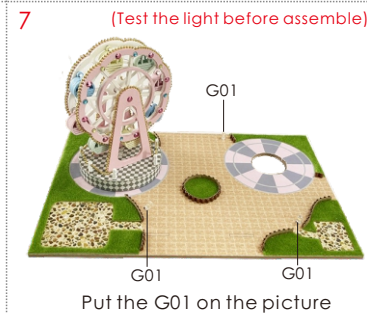
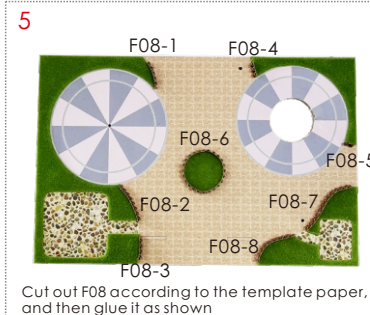
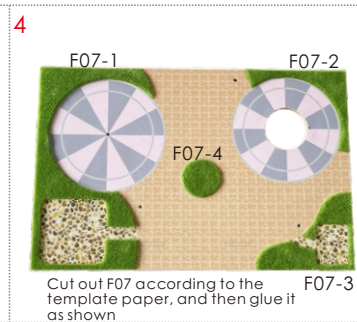
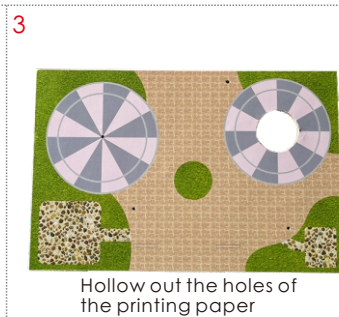
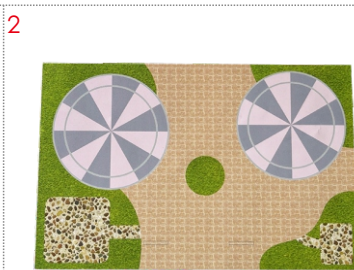
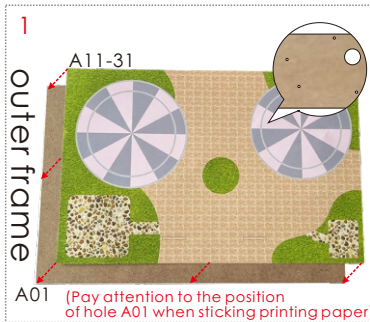

13



A05 is flush with A07-14 at the bottom

14



15



16

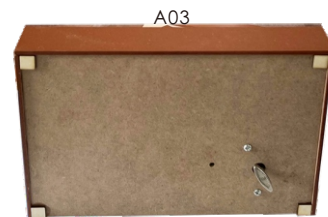

17

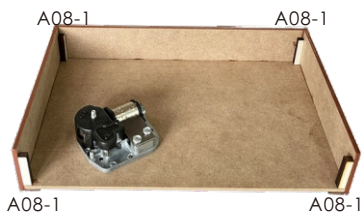

18

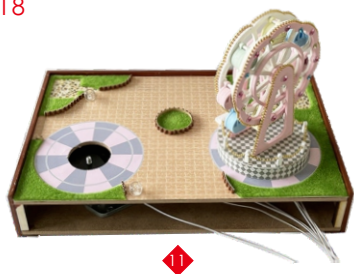

19

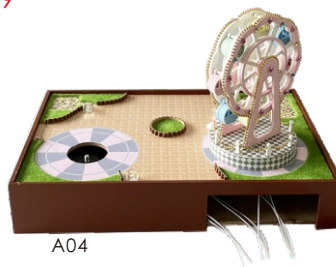

20



21



22

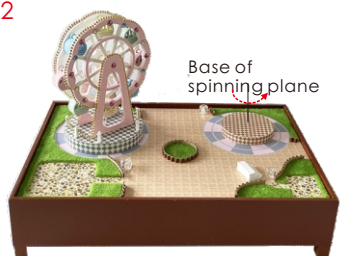

Screw the base of the rotating aircraft counterclockwise inside the movement

23

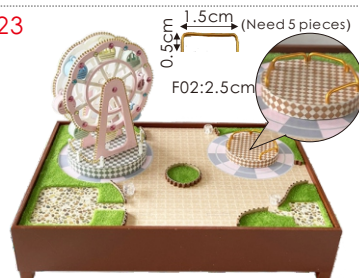

Cut the F02 into 5 sections of 2.5cm and then bend it according to template A07-15

24

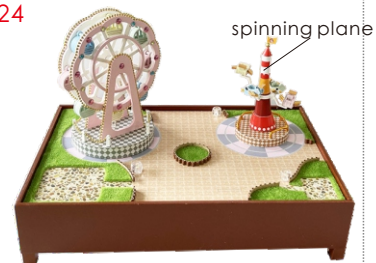

25



26

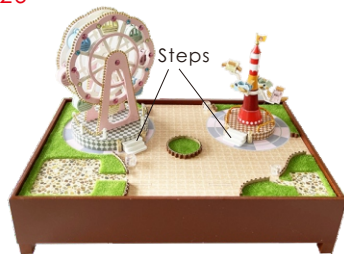

27



28

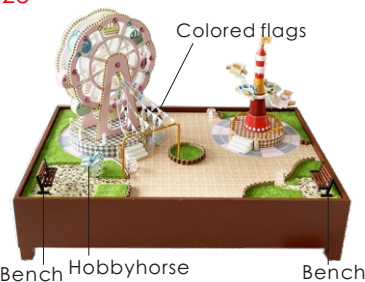

29



30



31

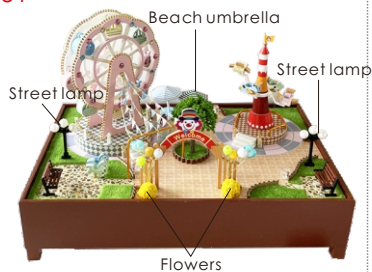

32



33



34



35



36



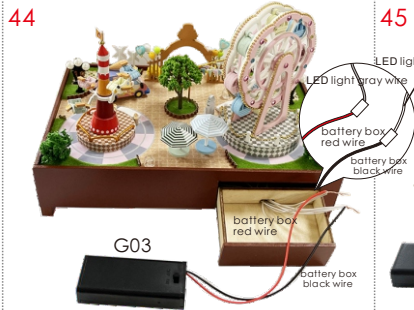
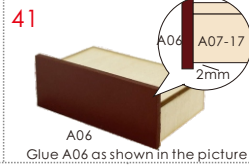
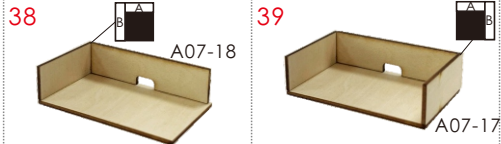
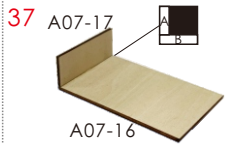

## How to assemble the battery holder

Statement: the lamp wires cannot be inserted into the output socket.

- - Can use 2\*AAA batteries
- - Please notice the place of anode and cathode when put in the batteries
- - Rechargeable batteries are not blunt electricity
- - Rechargeable batteries can only be charged under adult supervision
- - Rechargeable batteries should be removed from the toy before charging
- - Different types of batteries cannot mix. Do not mix new batteries in use with semi-used batteries.
- - Run out of battery should be removed from the toy
- - The power shall not be short circuit



Put the wire through the drawer of the battery box



Put the battery box in the drawer of the battery box



# Installation of dust cover

dust cover  
(Upgrade version accessories need to be purchased separately)



Ratio:1:10  
Z01 plexiglass (transparent)  
20\*13\*0.18(1piece)



Ratio:1:10  
Z02 plexiglass (transparent)  
14.5\*12.64\*0.18(2pieces)



Ratio:1:10  
Z03 plexiglass (transparent)  
20\*14.5\*0.18(2pieces)

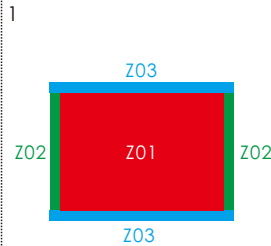

stick Z02 and Z03 on Z01.

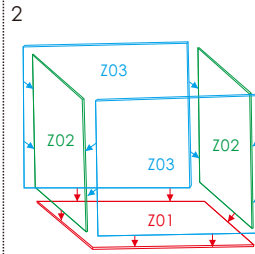

stick five pieces of plexiglass dust cover as shown



Ripped one side of kraft paper, leaving one side of kraft paper



Take out the plexiglass and tear off the kraft paper with text on each piece of plexiglass

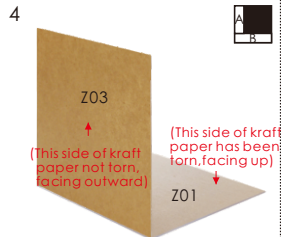

The kraft paper that has been ripped off faces inward, and the kraft paper that has not been ripped off faces outward.

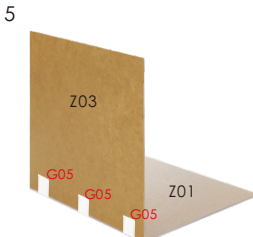

Use M03 to fix the junction of two pieces of plexiglass. (use transparent tape to replace M03)

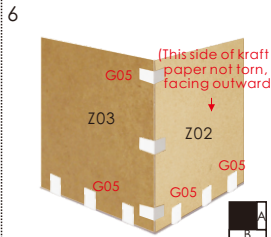

The junction of every two pieces of plexiglass needs to be fixed with M03 (to prevent the plexiglass falling off)

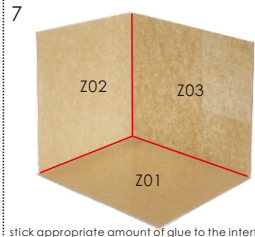

stick appropriate amount of glue to the interface of the two pieces of glass and scrape it slightly to make the glue penetrate into the junction of the two pieces of glass (the red line is the plexiglass interface)



The junction of two pieces of plexiglass needs to be fixed with M03 (to prevent the plexiglass falling off)

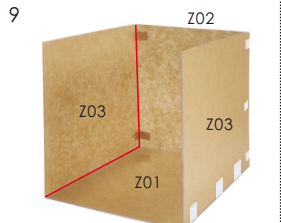

stick appropriate amount of glue to the interface of the two pieces of glass and scrape it slightly to make the glue penetrate into the junction of the two pieces of glass (the red line is the plexiglass interface)



The junction of two pieces of plexiglass needs to be fixed with M03 (to prevent the plexiglass falling off)

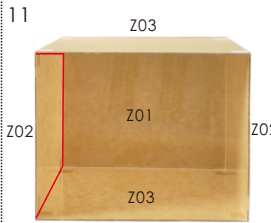

stick appropriate amount of glue to the interface of the two pieces of glass and scrape it slightly to make the glue penetrate into the junction of the two pieces of glass (the red line is the plexiglass interface)

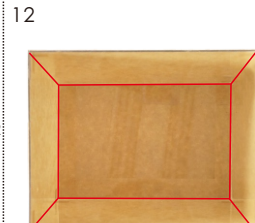

the dust cover need to be glued 8 interfaces

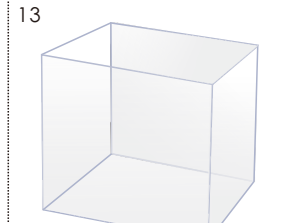

Leave it for 1 hour. After the glue dries out, tear off a layer of kraft paper outside the plexiglass

## Sence Display



## Details Display



## Combination display



The instruction manual should be keep, after assembled