

M914



Memories of Autumn Grocery Store

M914 Instruction manual

NOTICE OF ASSEMBLE

Tips for assembling

1. Pictures shown on the package may be slightly different from the actual product.
2. All the materials are taken in the operation step, put the remaining materials back into the original pocket until the installation is completed. (Avoid material loss during installation)
3. The dimensions indicated in the step diagram are "cm".
4. If there have template paper material, please cut the material according to the template to avoid mistakes..
5. According to the part rule example at the bottom of this page, refer to the part on the part number drawing, find the material object and compare with the material list, confirm and install. (Wooden parts only)
6. Glue should not be applied too much, so as not to dry longer, overflow will affect the effect of the finished product.
7. Part shapes may differ from the photographs depending on the production batch.

Testing on LED function

Be sure to test the LED lights before making the lighting, note that the LED white wire to the negative, gray wire to the positive reference to the following figure operation test.

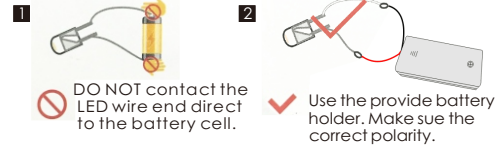

Product comes with tool:



Bring your own tools:

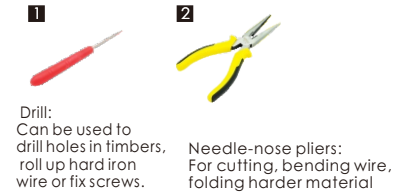

How to assemble the battery holder

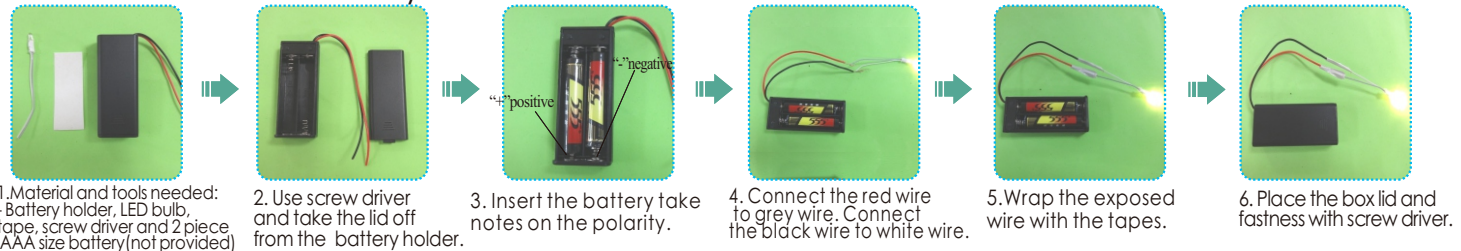

Example of parts rule:

A01: The parts are directly in the box.; B01: parts in bag B; C01: part in bag C, and so on.
(Note: display the printing paper A09-01 in the step: the printing paper is placed directly in the box, part number is A09-01)

details of miniature kit

Name	Material package	Name	Material package
printing paper	Bag A-A09(All printing and template papers are shown on A09 paper,total 4 pieces of A4)	electric pole and lantern	E bag + F bag + printing paper
bubble bottle	B bag + printing paper	floor tile	E bag + printing paper
tea bag	printing paper	signboard	E bag + printing paper
candy jar	F bag + printing paper	sunshade	C bag + printing paper
food pot	F bag + printing paper	door	C bag + F bag
rice bag	F bag + G bag + printing paper	outer frame	A bag + B bag + G bag + printing paper
box	G bag + printing paper	decoration	B bag + printing paper
mask	printing paper	battery holder	G bag
tea table	D bag + F bag		
seat cushion	D bag + F bag + G bag		
round stool	D bag		
sweets	F bag + G bag		
rice basket	G bag + printing paper + template paper		
gift box	D bag + F bag + printing paper		
cookie bag	printing paper		
book	D bag + F bag + printing paper		
business card	D bag + printing paper		
postbox tube	E bag + printing paper		



Welcome to the little DIY world, now come with me

Thumbnail of material list(reference only)



Thumbnail of printing paper & template paper(reference only)



Symbol description used



Install parts in the opposite direction



Install the same parts on both sides



Pay attention to the direction of installation material B



Pay attention to the direction of installation material A



Fold in half according to dotted line



fold double edge to center dotted line



Fold four sides to the middle



Pay attention to the direction of installation material A



Pay attention to the direction of installation material B



combination part according to 1 2 3 so on.



Bubble Bottle



Tea Bag

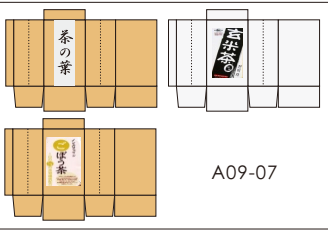

Candy Jar

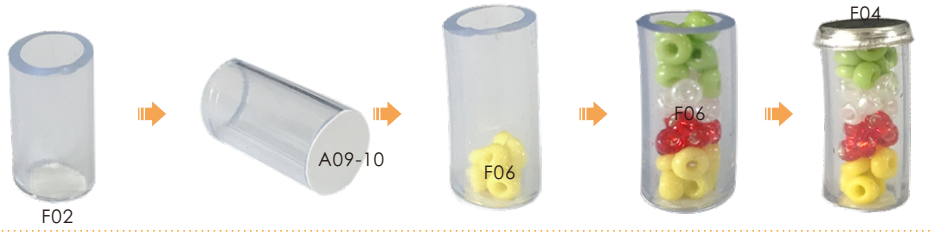

Food Pot

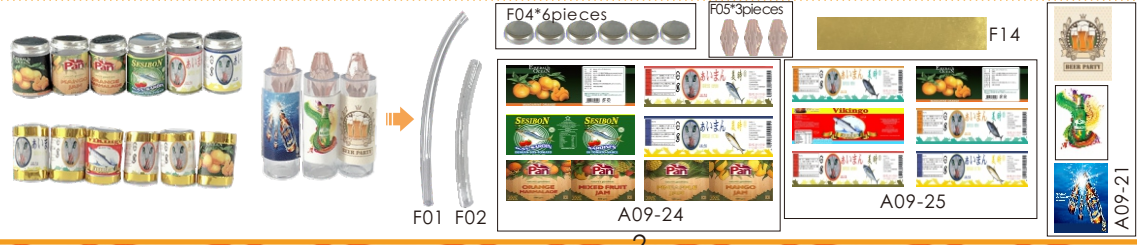

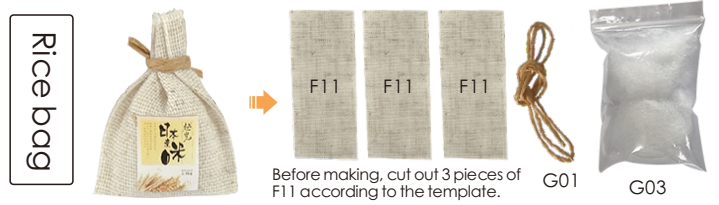



In the same way,
3 pieces are made.

BOX



Cut 25CM out of G01 and unscrew it into two strips,
leaving one strip at the back to make a rice basket.



Mask

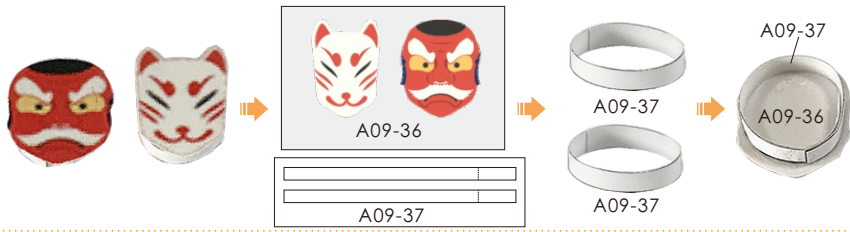

Tea table

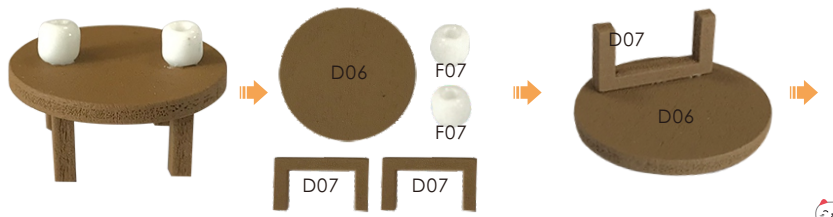



Seat cushion



Before making, cut out 2 pieces of F12 according to the template.



Round stool

In the same way, 2 pieces are made.

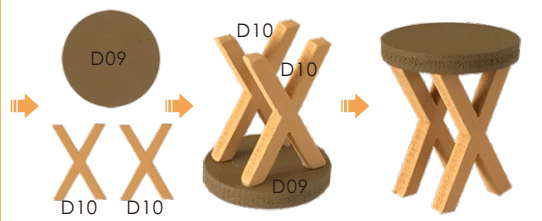

Sweets



Cut F13 into 2.5cm * 4pieces, 2cm * 2pieces and 1.5cm * 1piece.



Take appropriate amount of G03 and knead it into a ball.





Before making, cut out the G01 basket on the template paper.



Rice Basket



Gift Box



Cookie bag



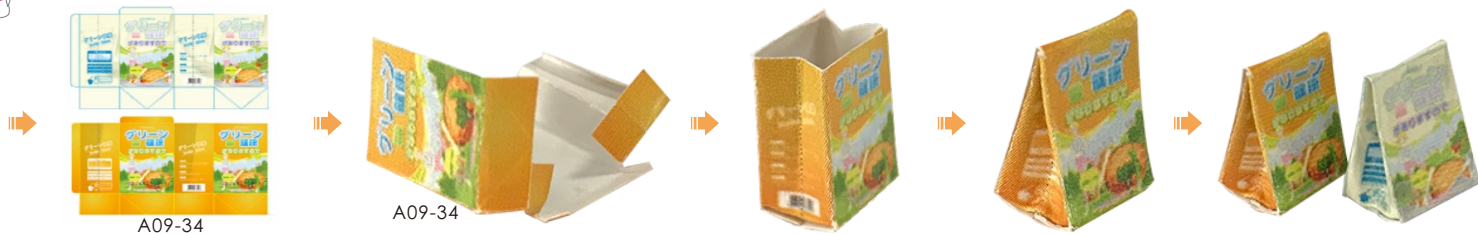

A09-34

A09-34

BOOK

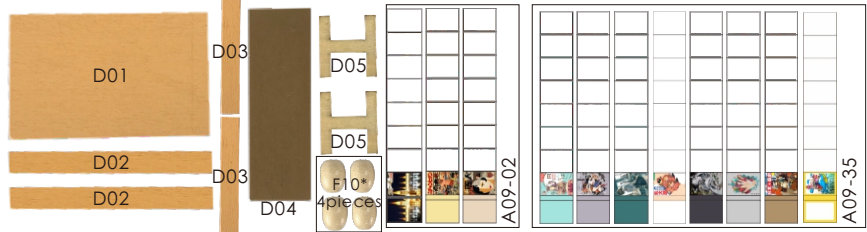

D01

D03

D05

D05

D03

D04

A09-02

A09-35



A09-02



A09-02



A09-02



A09-35

A09-35

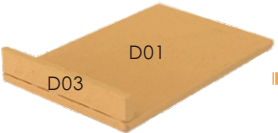

D01

D03

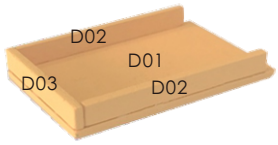

D02

D03

D01

D02

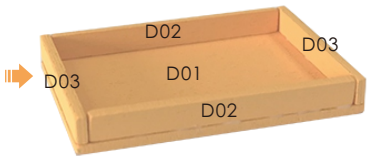

D02

D03

D01

D02

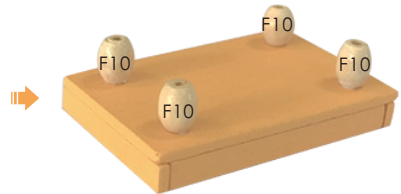

F10

F10

F10

A09-02



A09-35



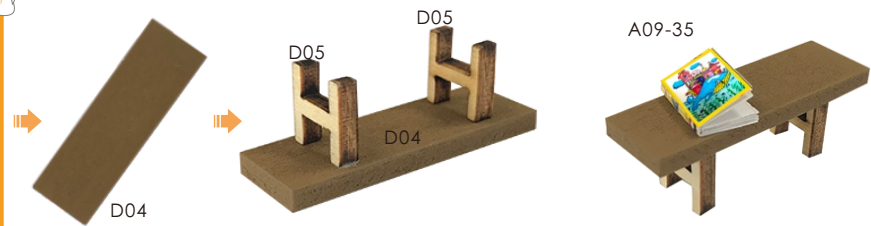

Business card

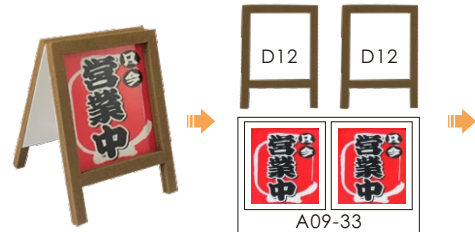

Postbox tube

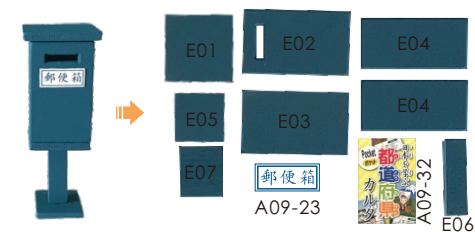

Floor Tile

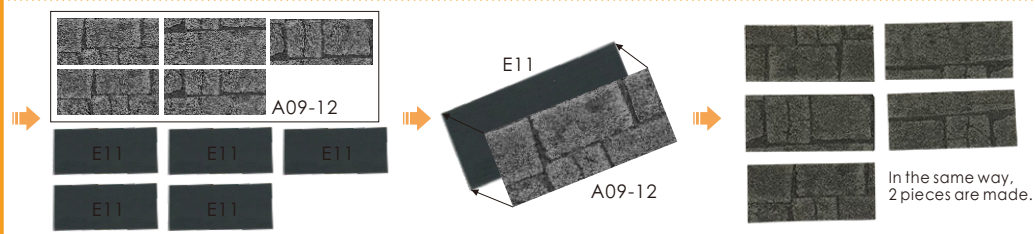

Electric Pole and Lantern

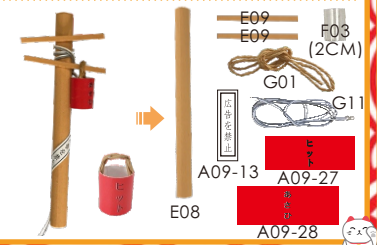



A09-27 Cut out 2.5CM from G01 and use it to make small lantern hanging rope; Cut out 3CM to make hanging rope for big lantern.

Cut G01 out to 7cm around.

A09-28

(Make two marks with tweezers.)

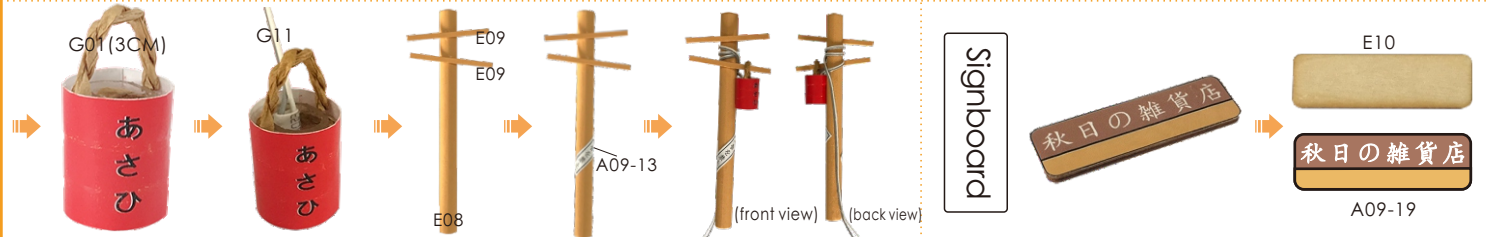

G01 (3CM)

G11

E09

E09

A09-13

E08

(front view)

(back view)

Signboard

E10

秋日の雑貨店

A09-19

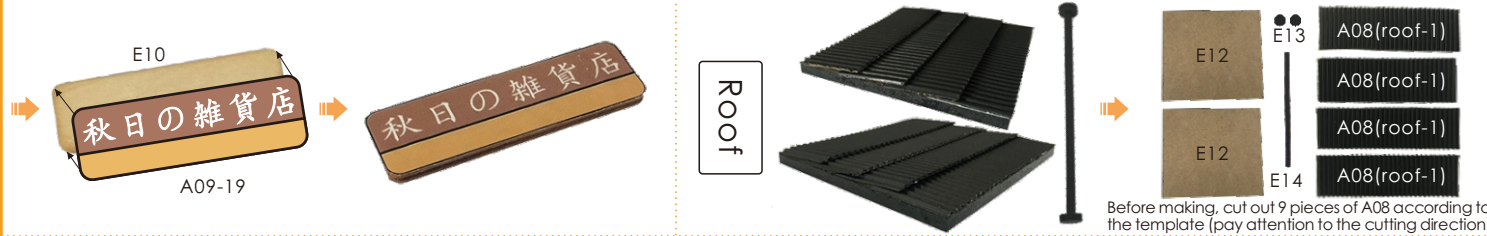

E10

A09-19

Roof

E12

E13

A08 (roof-1)

A08 (roof-1)

A08 (roof-1)

A08 (roof-1)

E14

Before making, cut out 9 pieces of A08 according to the template (pay attention to the cutting direction)



A08 (roof-1)

A08 (roof-1)

A08 (roof-1)

A08 (roof-1)

A08 (roof-2)

Leave this piece for later use.

F09

G11

E13

E14

E13

E12

A08 (roof-1)

A08 (roof-1)

A08 (roof-1)

A08 (roof-1)

A08 (roof-1)
4pieces



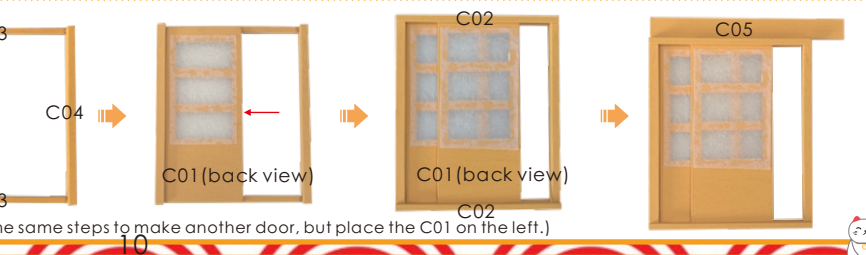
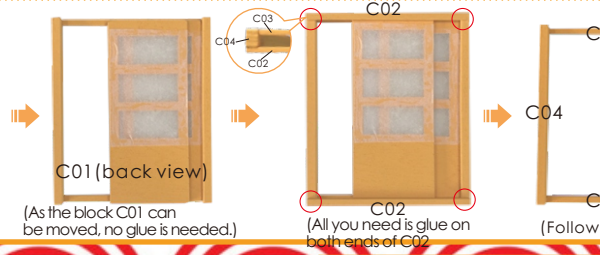
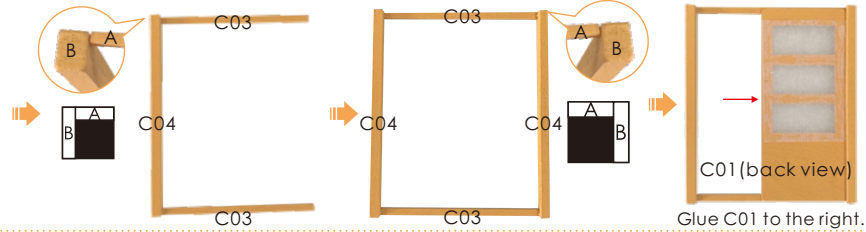
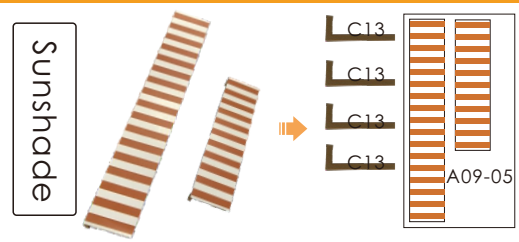

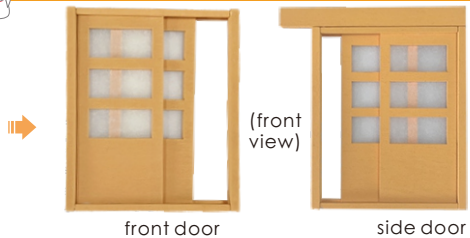

Shelf

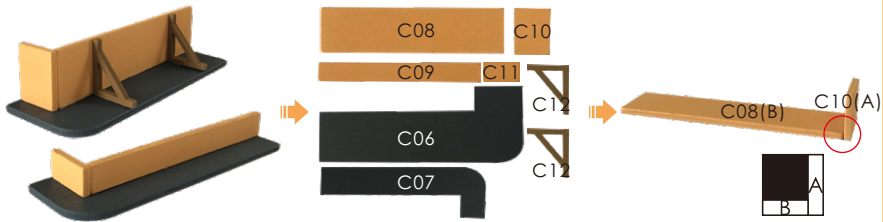

Outer frame



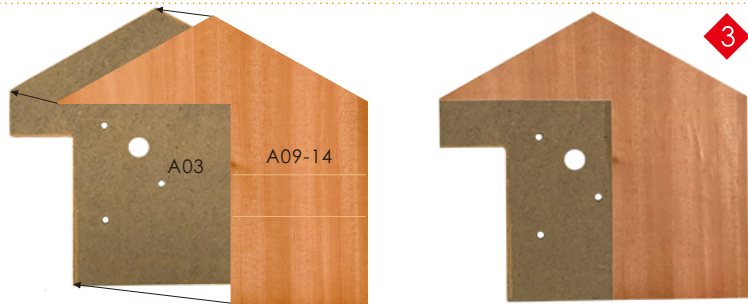
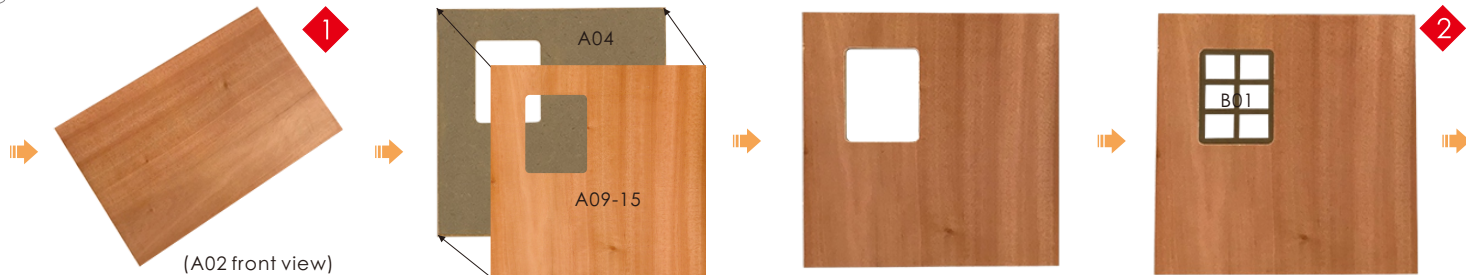

Music machine core manual guide
(if you have purchased the music machine core, please fix it firstly)

H01 Music machine core 1 piece

H02 Screw 3 pieces

H03 Music machine core handle 1 piece

H01

(front view)

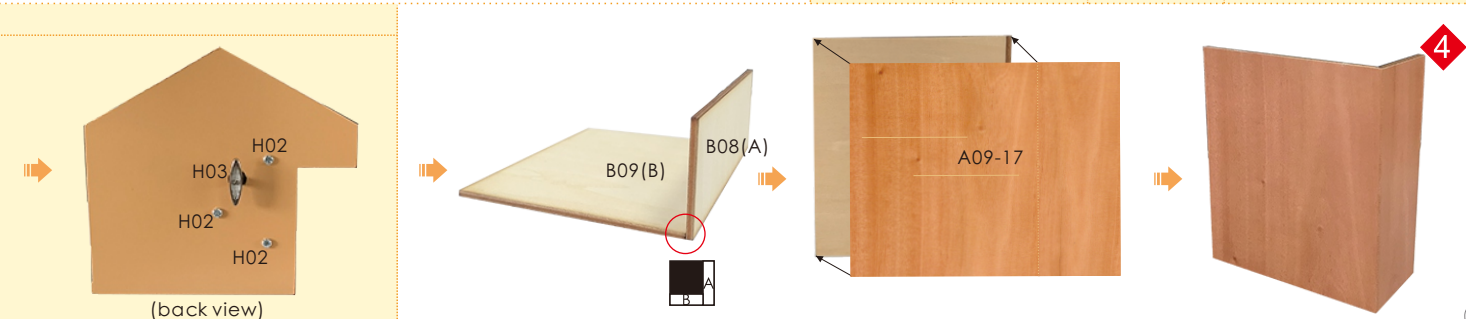

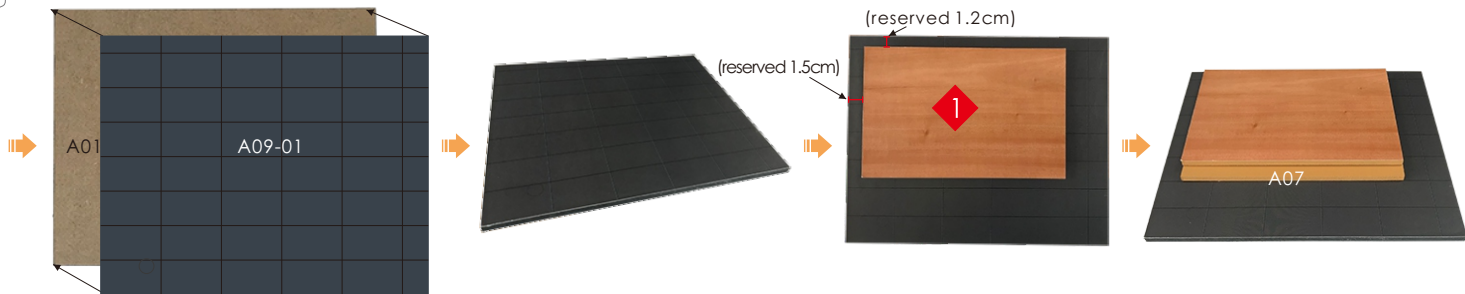

Decoration

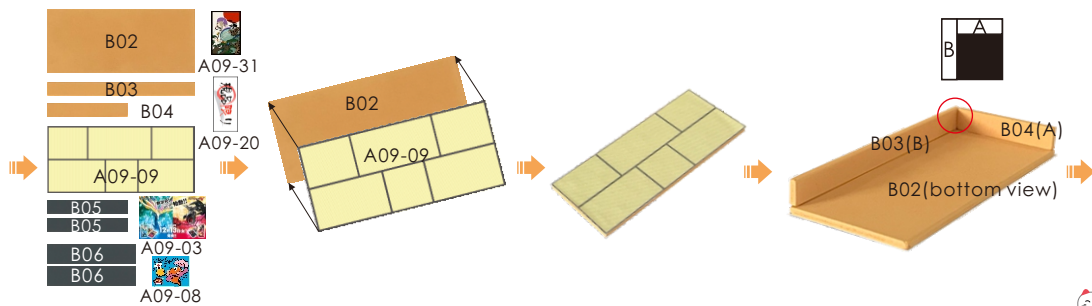

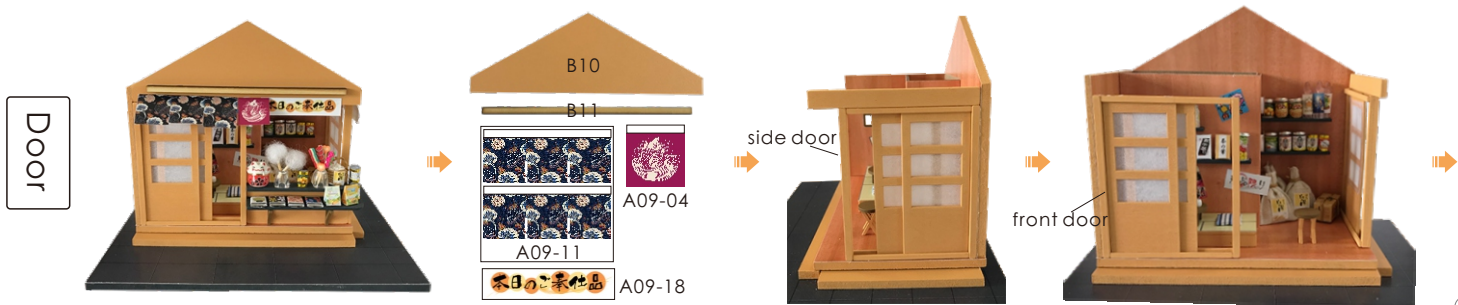
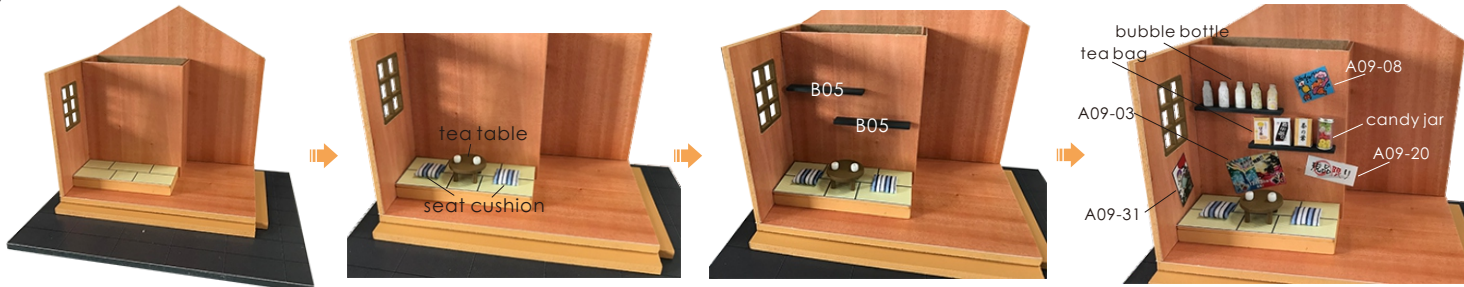



Roof installation





How to assemble the battery holder

1. Trim all the LED wiring to the same length.
2. Use a craft blade to carefully skim over the plastic to bare the copper wire. Twist the same color wire together.
3. Twist the following wire together:
 - (i) BLACK wire from the battery box with the WHITE wire from LED bulb.
 - (ii) RED wire from the battery box with the GREY wire from LED bulb.
4. Roll and seal the duly twist copper with the white tape G13 provided.

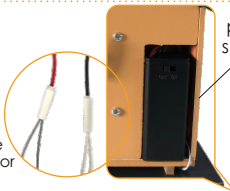

business card

electric pole



Statement: the lamp wires cannot be inserted into the output socket.

- Can use 7 batteries
- Please notice the place of anode and cathode when pit in the batteries
- Rechargeable batteries are not blunt electricity
- Rechargeable batteries can only be charged under adult supervision
- Rechargeable batteries should be removed from the toy before charging
- Different types of batteries cannot mix
- Do not mix new batteries in use with semi-used batteries.
- Run out of battery should be removed from the toy.
- The power shall not be short circuit.



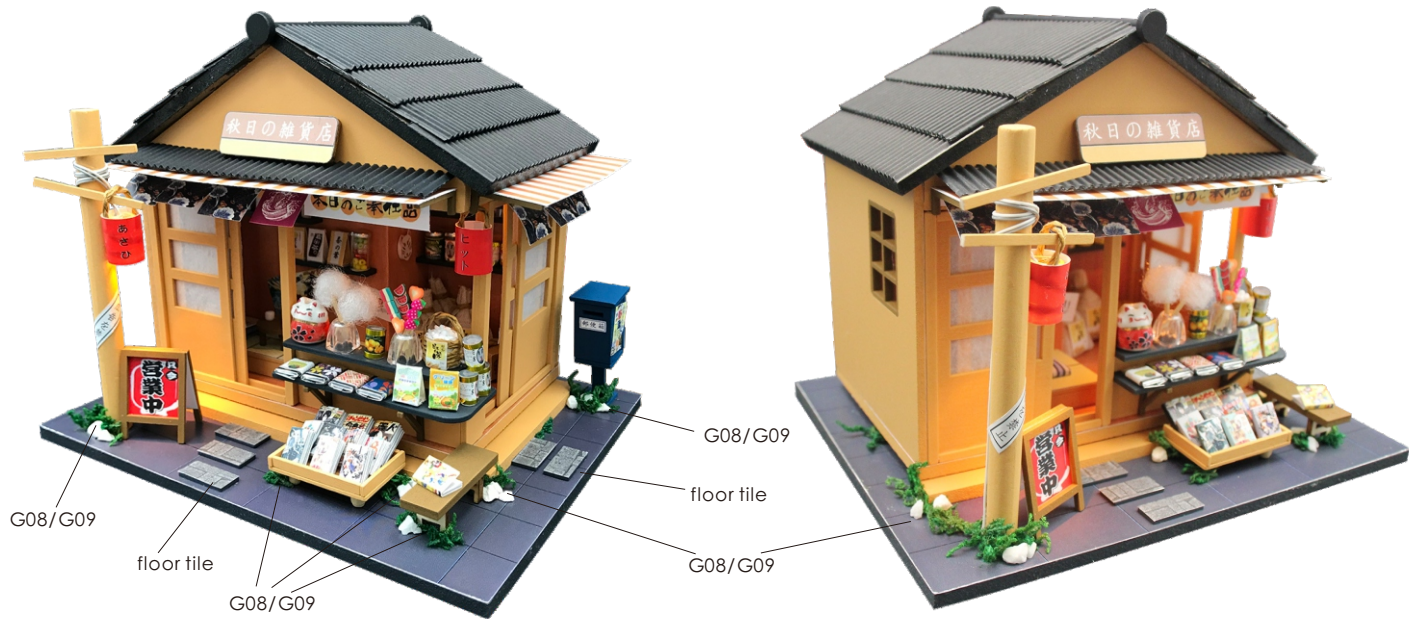

Installation of dust proof cover
 (For updated version, the parts need to be purchased separately)

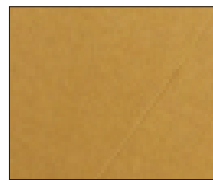

scale 1:7
 H04 Transparent cover
 16*19*0.18cm (2pieces)

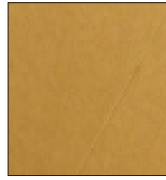

scale 1:7
 H05 Transparent cover
 14.64*16*0.18cm(2pieces)

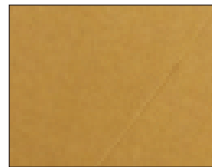

scale 1:7
 H06 Transparent cover
 15*19*0.18cm(1piece)

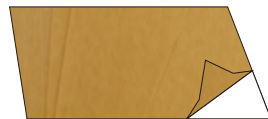

1. Tear off kraft paper of each piece of transparent cover.

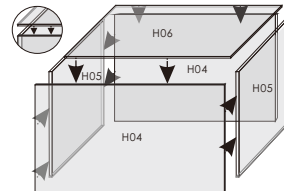

2. Paste H04, H05 and H06 together to complete the dust proof cover as shown.





Attention: Please keep the instruction for future enquires after installation.